

RACCORDI VARI

RACCORDO CURVO IN NYLON CON GIRELLO

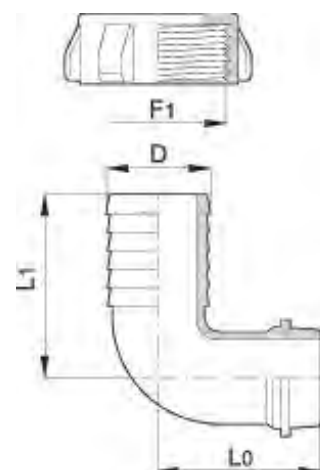

Codice	D	F1	L0	L1
11620	20 mm	M 29 x 1,75 mm	36,7 mm	45 mm
11621	25 mm	M 42 x 3 mm	50 mm	53 mm
11622	30 mm	M 42 x 3 mm	53 mm	60 mm
11623	35 mm	M 52 x 3 mm	64,5 mm	78 mm
11624	40 mm	M 52 x 3 mm	64,5 mm	84,5 mm
11625	50 mm	M 67 x 3 mm	76 mm	90 mm



RACCORDO DRITTO IN NYLON CON GIRELLO



Codice	D	F1	L0
11615	20 mm	M 29 x 1,75 mm	44,5 mm
13041	25 mm	M 42 x 3 mm	52,5 mm
13042	30 mm	M 42 x 3 mm	60 mm
13043	35 mm	M 52 x 3 mm	68 mm
13044	40 mm	M 52 x 3 mm	68 mm
13045	50 mm	M 67 x 3 mm	76 mm

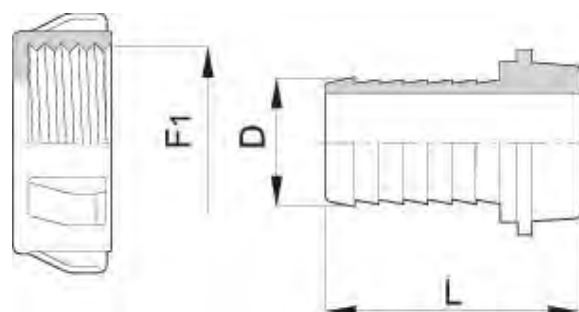

RACCORDO PORTAGOMMA DRITTO MASCHIO IN NYLON



Codice	D	F1	L0
13052	20 mm	M 29 x 1,75 mm	44,5 mm
13046	25 mm	M 42 x 3 mm	52,5 mm
13047	30 mm	M 42 x 3 mm	61 mm
13048	35 mm	M 52 x 3 mm	68 mm
13049	40 mm	M 52 x 3 mm	68 mm
13051	50 mm	M 67 x 3 mm	73 mm

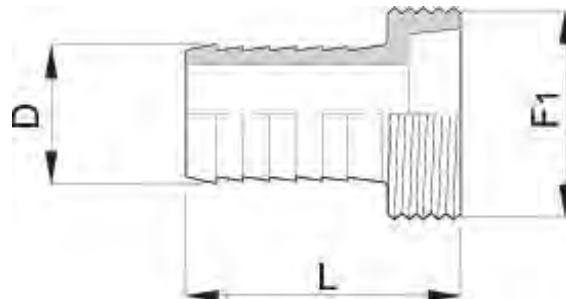

RACCORDO TRE PEZZI IN NYLON



Codice	D	F1	L0	L1
14400	20 mm	M 29 x 1,75 mm	44,5 mm	44,5 mm
14401	25 mm	M 42 x 3 mm	52,5 mm	52,5 mm
14402	30 mm	M 42 x 3 mm	60 mm	61 mm
14403	35 mm	M 52 x 3 mm	68 mm	68 mm
14404	40 mm	M 52 x 3 mm	68 mm	68 mm
14405	50 mm	M 67 x 3 mm	76 mm	73 mm

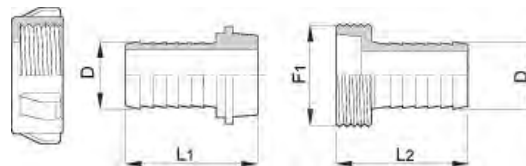

RACCORDO NIPPLO IN NYLON



Codice	CH	F	F1	L
14409	27 mm	G 3/4	M 29 x 1,75 mm	34 mm
14410	32 mm	G 1	M 29 x 1,75 mm	35 mm
14411	32 mm	G 1	M 42 x 3 mm	43 mm
14413	38 mm	G 1 1/4	M 52 x 3 mm	52 mm
14414	46 mm	G 1 1/2	M 52 x 3 mm	52 mm
14415	56 mm	G 2	M 67 x 3 mm	52 mm

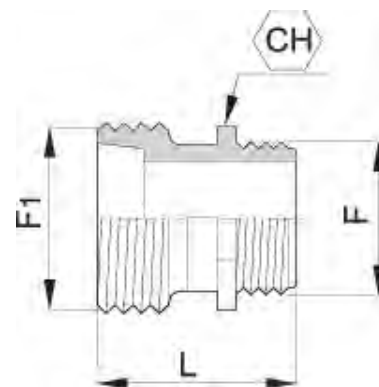

RACCORDO PORTAGOMMA DRITTO MASCHIO IN NYLON



Codice	D	F	h	L
16626	20 mm	G 3/4	22 mm	71 mm
16627	25 mm	G 1	22 mm	72,5 mm
16628	30 mm	G 1 1/4	24 mm	80 mm
16629	40 mm	G 1 1/2	24 mm	90 mm

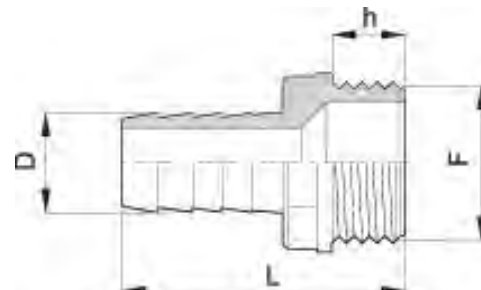

RACCORDO PORTAGOMMA CURVO MASCHIO IN NYLON



Codice	D	F	h	L0	L1
16636	20 mm	G 3/4	22 mm	50 mm	53 mm
16637	25 mm	G 1	22 mm	59 mm	53 mm
16638	30 mm	G 1 1/4	24 mm	62 mm	60 mm
16639	40 mm	G 1 1/2	24 mm	70 mm	84,5 mm

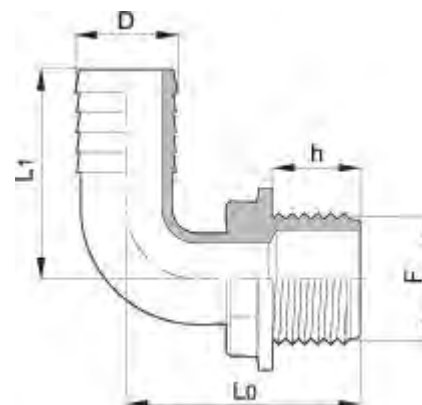

RACCORDI CURVI IN NYLON PER IMBOTTIGLIAMENTO



Codice	D	F	L0	L1
17766	13 mm	M29x1.75 mm	42,5 mm	34,5 mm

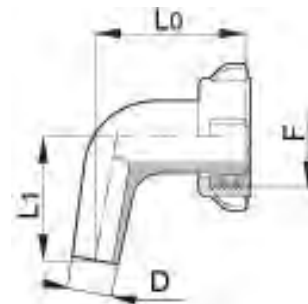

17767	13 mm	M37x3 mm	47 mm	61 mm
-------	-------	----------	-------	-------

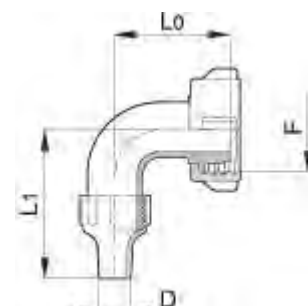

17768	14 mm	M42x3 mm	53 mm	63,5 mm
-------	-------	----------	-------	---------

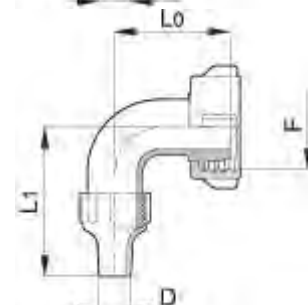

17769	16 mm	M52x3 mm	64,5 mm	89 mm
-------	-------	----------	---------	-------

